

A417 Missing Link
TR010056

2.7c Traffic Regulation Measures Classification of Roads

Planning Act 2008

APFP Regulation 5(2)(o)
Infrastructure Planning (Applications: Prescribed Forms and
Procedure) Regulations 2009

Volume 2

May 2021

Infrastructure Planning

Planning Act 2008

**The Infrastructure Planning
(Applications: Prescribed Forms
and Procedure) Regulations 2009**

A417 Missing Link

Development Consent Order 202[x]

2.7c Traffic Regulation Measures - Classification of Roads

Regulation Number:	5(2)(o)
Planning Inspectorate Scheme Reference	TR010056
Application Document Reference	2.7c
Author:	A417 Missing Link

Version	Date	Status of Version
C01	May 2021	Application Submission

Content

1. 2.7c Traffic Regulation Measures APFP Regulations 5(2)(o) Classification of Roads - Key Plan
2. 2.7c Traffic Regulation Measures APFP Regulations 5(2)(o) Classification of Roads - Sheet 1 of 6
3. 2.7c Traffic Regulation Measures APFP Regulations 5(2)(o) Classification of Roads - Sheet 2 of 6
4. 2.7c Traffic Regulation Measures APFP Regulations 5(2)(o) Classification of Roads - Sheet 3 of 6
5. 2.7c Traffic Regulation Measures APFP Regulations 5(2)(o) Classification of Roads - Sheet 4 of 6
6. 2.7c Traffic Regulation Measures APFP Regulations 5(2)(o) Classification of Roads - Sheet 5 of 6
7. 2.7c Traffic Regulation Measures APFP Regulations 5(2)(o) Classification of Roads - Sheet 6 of 6

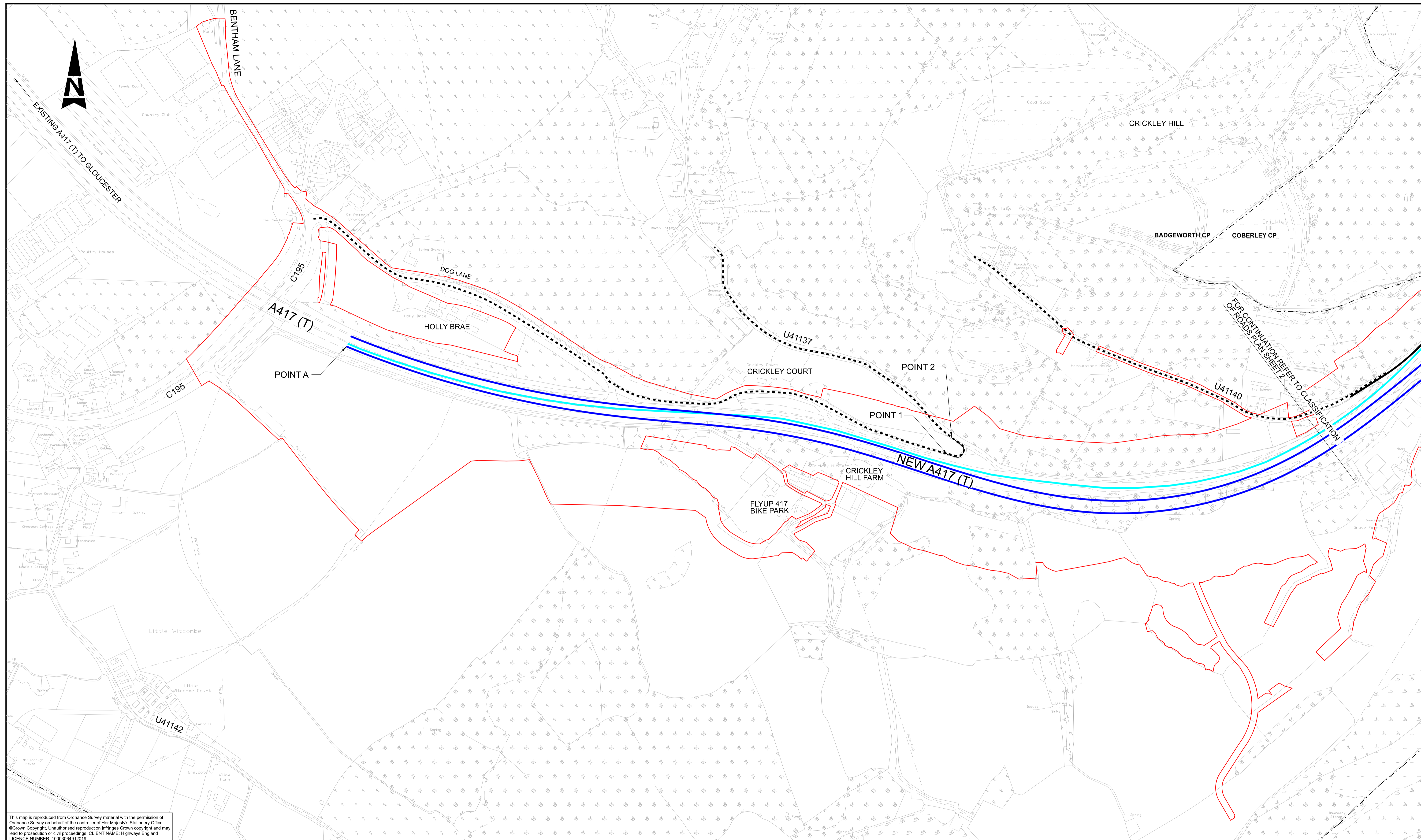

This map is reproduced from Ordnance Survey material with the permission of Ordnance Survey on behalf of the controller of Her Majesty's Stationery Office. © Crown Copyright. Unauthorised reproduction infringes Crown copyright and may lead to prosecution or civil proceedings. CLIENT NAME: Highways England LICENCE NUMBER: 100030649 (2019)

- NOTES
- ALL DIMENSIONS ARE IN METRES UNLESS NOTED OTHERWISE.
 - POINTS REFER TO SCHEDULE 3 PARTS 1, 3 AND 4 OF THE DRAFT DEVELOPMENT CONSENT ORDER

- LEGEND:
- DEVELOPMENT CONSENT ORDER BOUNDARY
 - EXISTING A417 (T)
 - NEW A417(T)
 - EXISTING A436
 - EXISTING B ROADS
 - EXISTING C ROADS
 - EXISTING UNCLASSIFIED ROADS
 - NEW CLASSIFIED ROADS
 - NEW UNCLASSIFIED ROADS
 - - - PARISH BOUNDARIES
 - U41140 UNCLASSIFIED ROAD REFERENCE NUMBER

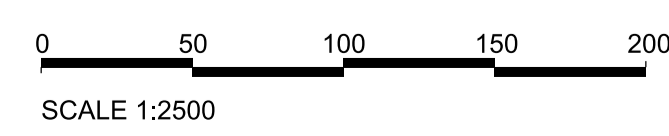
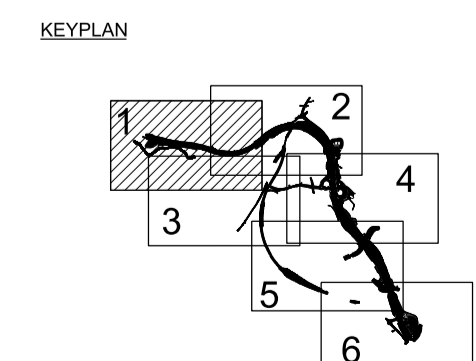

CO1	21/05/21	APPLICATION SUBMISSION (MAY 2021)	JF	DA	JP	YB
Rev.	Date	Description	By	Chk'd	App'd	Auth'd

Suitability **A3** Drawing Status **STAGE COMPLETED**



Project Title **A417 MISSING LINK**

Drawing Title TRAFFIC REGULATION MEASURES APFP REGULATIONS 5(2)(o) CLASSIFICATION OF ROADS - SHEET 1 OF 6 APPLICATION NUMBER: TR010056					
Scale 1:2500	By JF	Checked DA	Approved JP	Authorised YB	
Original Size A1	Date 20/05/21	Date 20/05/21	Date 21/05/21	Date 21/05/21	
Drawing Number HE PIN HE551505	Originator ARP	Volume LSI	Revision C01		
X_XX_XXXX_X	-DR -ZL	-000721			
Location	Type	Role	Number		

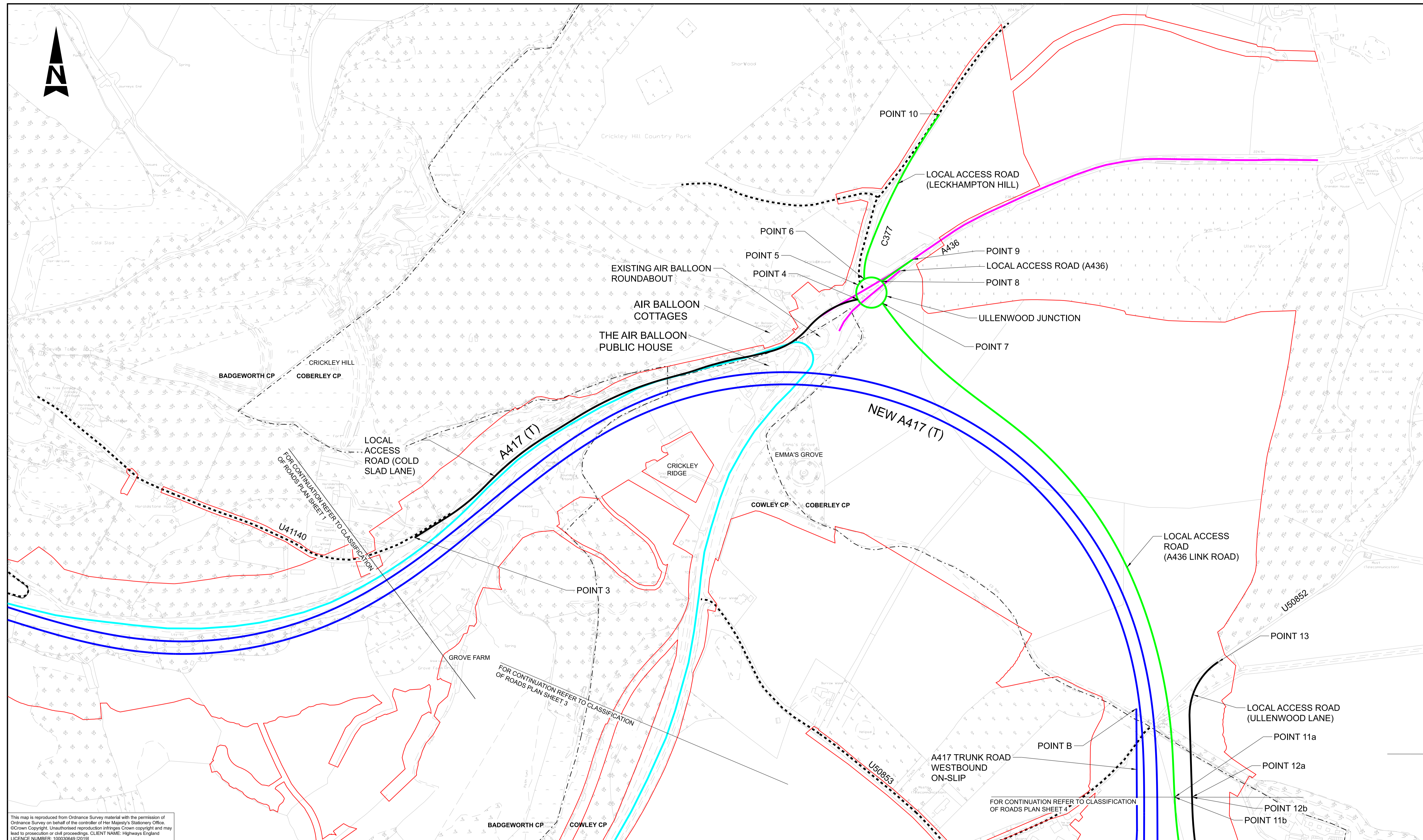

This map is reproduced from Ordnance Survey material with the permission of Ordnance Survey on behalf of the controller of Her Majesty's Stationery Office. © Crown Copyright. Unauthorised reproduction infringes Crown copyright and may lead to prosecution or civil proceedings. CLIENT NAME: Highways England LICENCE NUMBER: 100030649 (2019)

- NOTES**
- ALL DIMENSIONS ARE IN METRES UNLESS NOTED OTHERWISE.
 - POINTS REFER TO SCHEDULE 3 PARTS 1, 3 AND 4 OF THE DRAFT DEVELOPMENT CONSENT ORDER

LEGEND:

	DEVELOPMENT CONSENT ORDER BOUNDARY		NEW CLASSIFIED ROADS
	EXISTING A417 (T)		NEW UNCLASSIFIED ROADS
	NEW A417(T)		PARISH BOUNDARIES
	EXISTING A436		U41140 UNCLASSIFIED ROAD REFERENCE NUMBER
	EXISTING B ROADS		
	EXISTING C ROADS		
	EXISTING UNCLASSIFIED ROADS		

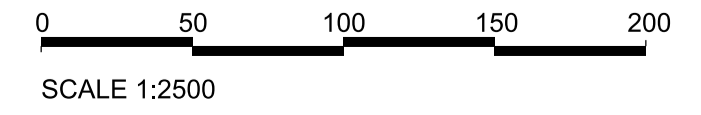
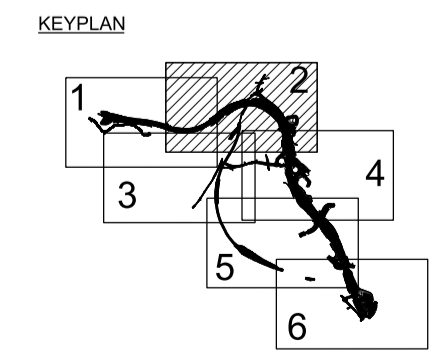

Rev.	Date	Description	By	Chk'd	App'd	Auth'd
C01	21/05/21	APPLICATION SUBMISSION (MAY 2021)	JF	DA	JP	YB

Suitability	A3
Drawing Status	STAGE COMPLETED

Project Title: **A417 MISSING LINK**

Drawing Title: **TRAFFIC REGULATION MEASURES
APFP REGULATIONS 5(2)(o)
CLASSIFICATION OF ROADS - SHEET 2 OF 6
APPLICATION NUMBER: TR010056**

Scale	1:2500	By	JF	Checked	DA	Approved	JP	Authorised	YB
Original Size	A1	Date	20/05/21	Date	20/05/21	Date	21/05/21	Date	21/05/21

Drawing Number	HE PIN	Originator	Volume	Revision
HE551505	-	ARP	-	LSI
X_XX_XXXX_X	-	DR - ZL	-	000722
Location	Type	Role	Number	



C01

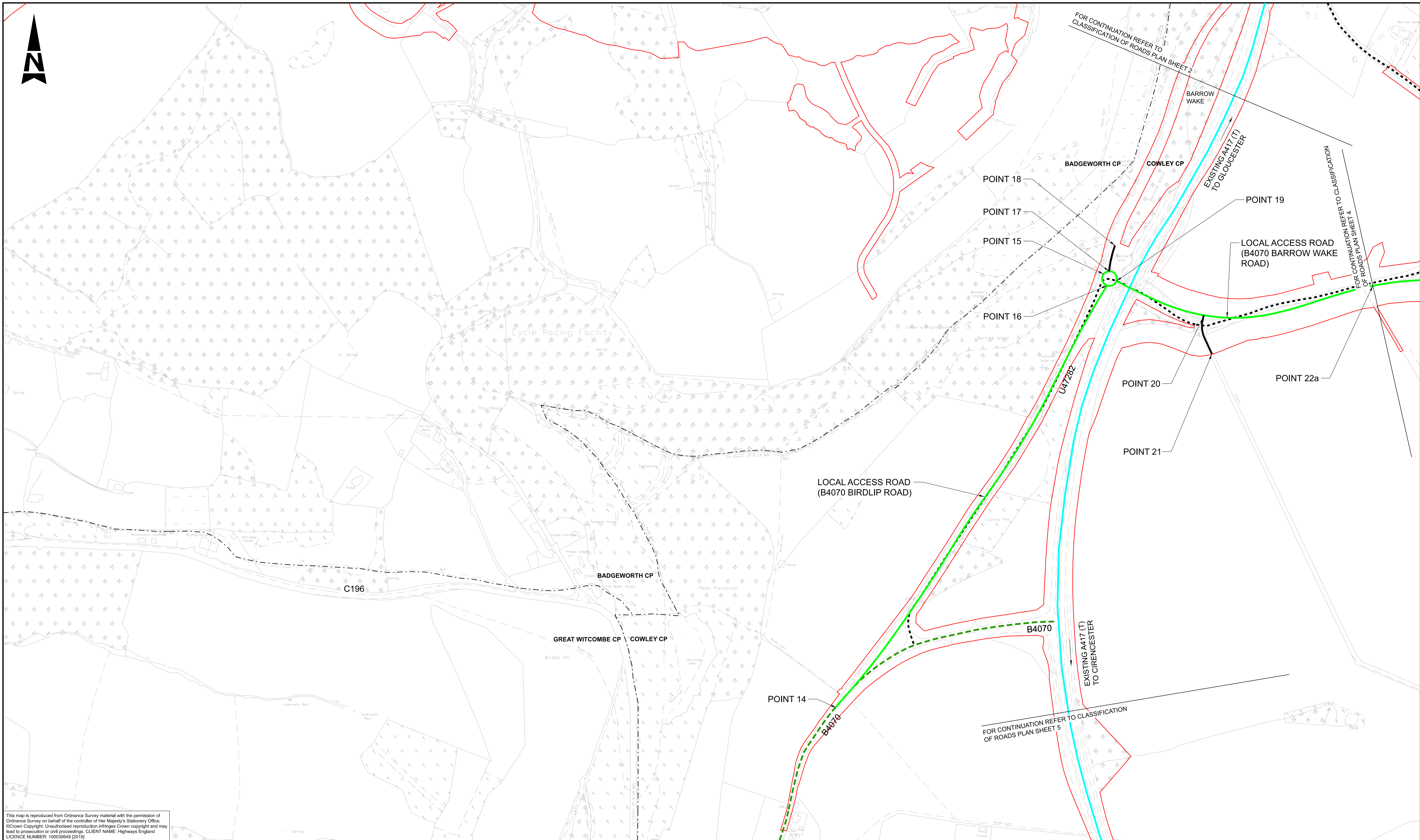

This map is reproduced from Ordnance Survey material with the permission of Ordnance Survey on behalf of the controller of Her Majesty's Stationery Office. © Crown Copyright. Unauthorised reproduction infringes Crown copyright and may lead to prosecution or civil proceedings. CLIENT NAME: Highways England LICENCE NUMBER: 100030649 (2019)

- NOTES**
- ALL DIMENSIONS ARE IN METRES UNLESS NOTED OTHERWISE.
 - POINTS REFER TO SCHEDULE 3 PARTS 1, 3 AND 4 OF THE DRAFT DEVELOPMENT CONSENT ORDER

- LEGEND:**
- DEVELOPMENT CONSENT ORDER BOUNDARY
 - EXISTING A417 (T)
 - NEW A417(T)
 - EXISTING A436
 - EXISTING B ROADS
 - EXISTING C ROADS
 - EXISTING UNCLASSIFIED ROADS
 - NEW CLASSIFIED ROADS
 - NEW UNCLASSIFIED ROADS
 - PARISH BOUNDARIES
 - U41140 UNCLASSIFIED ROAD REFERENCE NUMBER

KEYPLAN

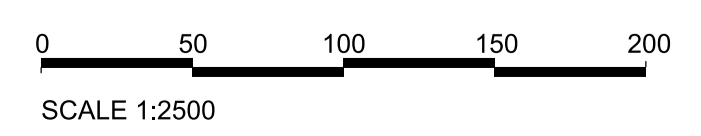
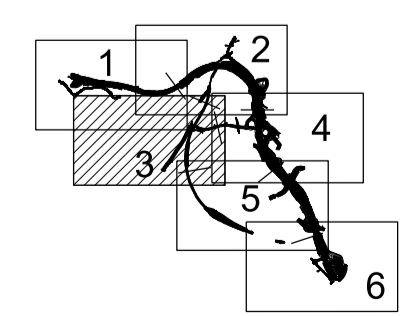

CO1	21/05/21	APPLICATION SUBMISSION (MAY 2021)	JF	DA	JP	YB
Rev.	Date	Description	By	Chk'd	App'd	Auth'd

Suitability Drawing Status
A3 STAGE COMPLETED

Client

Project Title
A417 MISSING LINK

Drawing Title
**TRAFFIC REGULATION MEASURES
APFP REGULATIONS 5(2)(o)
CLASSIFICATION OF ROADS - SHEET 3 OF 6
APPLICATION NUMBER: TR010056**

Scale	1:2500	By	JF	Checked	DA	Approved	JP	Authorised	YB
Original Size	A1	Date	20/05/21	Date	20/05/21	Date	21/05/21	Date	21/05/21
Drawing Number	HE PIN HE551505 -	Originator	ARP	Volume	LSI	C01			
Location	X_XX_XXXX_X	Type	-DR - ZL	Role	-000723				

